

Terremoto

Michelle Campos Castillo

June 9th - August 13th, 2022

Exhibition Map:

1. ***Terremoto, 2022***

Mural, acrylic paint

2. El Salvadoran Hammock

3. ***Interview with Mila***

Animation, 1m 56s duration,
Spanish with English Subtitles.

4. ***Interview with Mami***

Animation, 34s duration, Spanish
with English Subtitles.



grunt gallery

#116 - 350 East 2nd Avenue

Vancouver, BC, V5T 4R8

Phone: 604-875-9516

Hours: Tuesday – Saturday, Noon-5pm

Accessibility Notes:

- Artworks are not meant to be touched. A visual description of all works are available in the (A) Exhibition Binder in English.
- A power outlet is also here (A).
- Masks are mandatory in the space, and a sanitization station (A) is available for handcleaning upon entry.
- A creative access tour is being recorded and will be available soon in the orange KOBO player (a). A written transcript is available in the binder.
- Any questions or feedback are welcome at access@grunt.ca or by calling 604-875-9516.

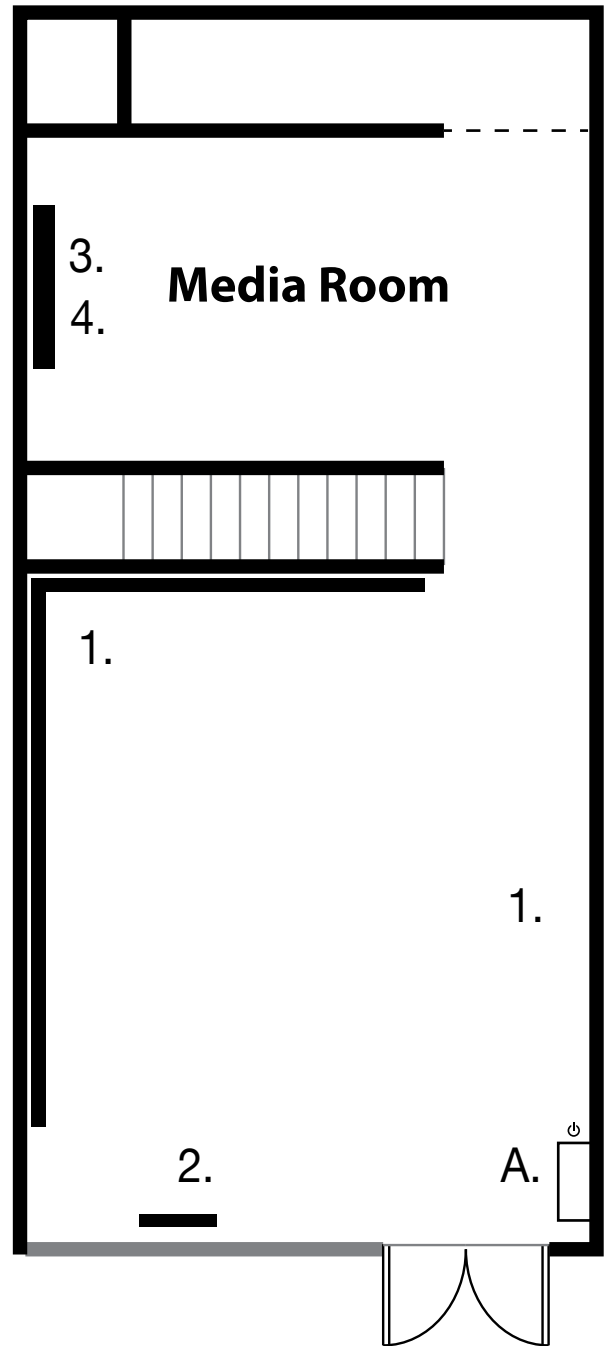

Thursday Low Sensory/Voice-Off:

From Noon-5 PM, our exhibition manager, Kay Slater, will offer a low-sensory and/or voice-off experience to visitors wishing to visit the space and our exhibitions.

Goals: Scent-reduced, silent, with accessible resources.
To learn more visit grunt.ca/low-sensory.